

MAINTENANCE ROUTINE

Flat Sealed Covers - Square

To ensure satisfaction of operation, it is essential that certain maintenance elements are carried out on a regular basis to assist with Management / Monitoring of the information to assess the integrity of the system.

1

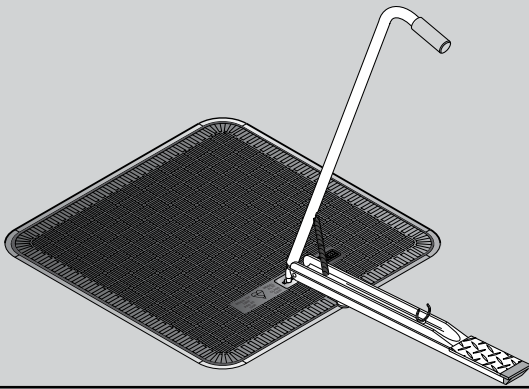

The purpose designed lifting aid (FL7A) must be used at all times to remove and replace the Fibrelite cover. Failure to use the specifically designed lifting aid may result in damage to the cover and injury.

2



Never attempt to roll or drop the cover as this may cause serious damage to the cover.

3

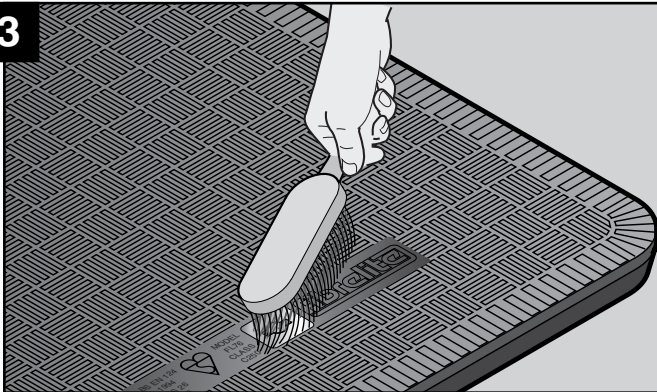

Do not remove the rubber bung from the base of the cover key housing. Remove debris from the key housing with suitable tools.

4

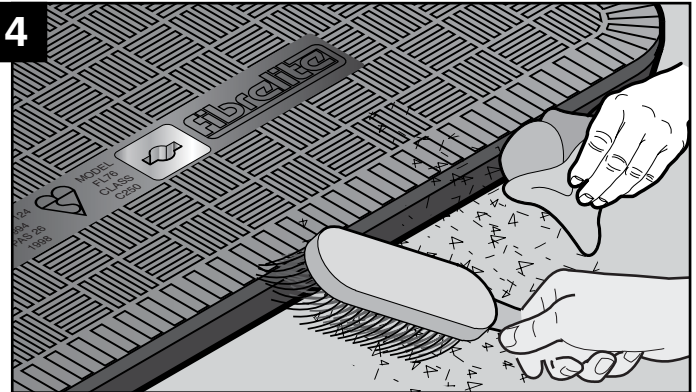

Ensure that the sealing faces of the cover are clean and free from debris as this may damage the seal and compromise the covers water tight effectiveness. It is recommended that a soft bristle brush or clean rag be used to clean the cover.

5

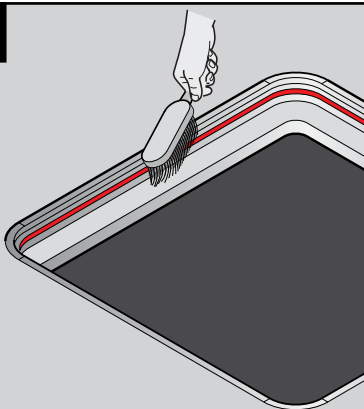

The frame and seal must be kept free from debris as this may cause damage to the cover. It is recommended that the frame be cleaned with a brush during removal and replacement.

6

IN CLIMATES THAT DROP BELOW FREEZING (0°C - 32°F)

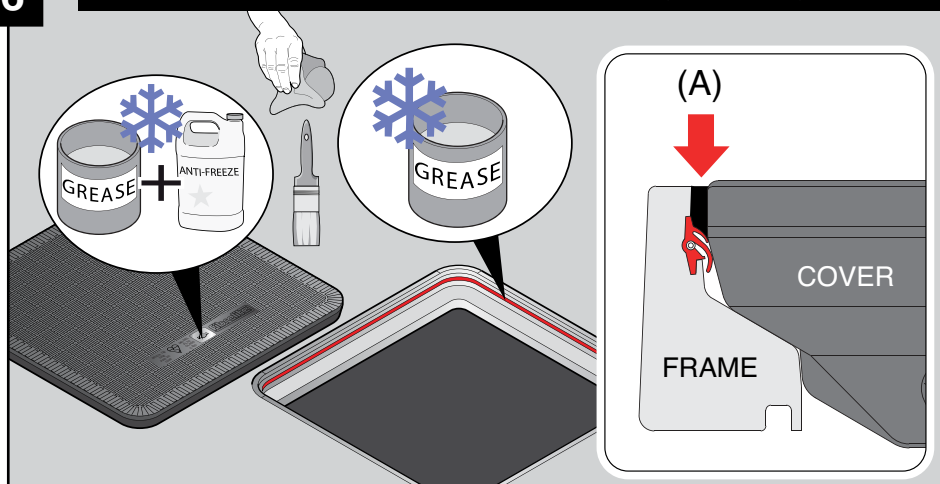

It is recommended that the key housing be filled with grease and anti-freeze and the seal be coated with **strictly** a non-petroleum based grease (preferably silicone).

(A) The void about the seal, between the frame and cover should be filled with grease. **This void/gap must be kept free from road salt and debris.**